

The Plaza



Be part of Park West

RETAIL AND OFFICE OPPORTUNITIES
IN IRELAND'S LARGEST BUSINESS PARK.

The Plaza, Park West, Nangor Road, Dublin 12



LIVE  PLAY  EAT  WORK  SHOP 



The Plaza is a 25,000 sq m office, retail and leisure complex in the heart of Parkwest

SCHEDULE OF ACCOMMODATION

Unit 1	Spar	Unit 10	Parkwest Tavern
Unit 2	Parkwest Pharmacy	Unit 11	1,108 Sq Ft
Unit 3	Insomnia Cafe	Unit 12/13	1,065 Sq Ft
Unit 4	1,151 Sq Ft	Unit 14-16	1,345 Sq Ft
Unit 5	Office Centre	Unit 17-19	1,840 Sq Ft
Unit 6/7	2,690 Sq Ft	Unit 20-22	3,724 Sq Ft
Unit 8	1,151 Sq Ft	Block 73	25,000 Sq Ft
Unit 9	Giraffe Childcare		

8,000 employees in the park

- Extensive surrounding business and residential population includes the Naas Road and Clondalkin area
- The Plaza is located in Parkwest, close to the M50 Naas Road junction
- The entire scheme comprises 93 hectares of prime business campus accommodation
- It is home to over 280 companies
- Has 8,000 employees on site
- The scheme houses 420,000 sq m of office, residential and industrial accommodation to date
- Currently 450 apartments completed - next phase due to commence
- Occupiers include Allianz Worldwide Care, Workhuman, Nostra, Tech Data, Sysnet Global Solutions, Auralia Clinic, Rehab Group, Irish Kidney Association, Nissan Ireland, Openet, Sungard & Silent-Aire
- Aspect Hotel

→ For more information visit parkwest.ie



Travel Times

*Source: Google Maps, travel times may vary.



7 Mins
drive to
the N7*



10 Mins
drive to
the M50*



47 Mins
LUAS to
City Centre





Location

Access to Parkwest is via car, train, Commuter line, Luas and Quality Bus Corridors.

Specification

All units provided to shell specification with all main services available. The units are flexible and capable of amalgamation or sub division.

Lease Terms

Flexible lease terms available.



The Plaza

The Plaza is an office, retail and leisure complex in the heart of Parkwest.

Current retail occupiers include Spar, Insomnia, Giraffe Childcare and Park West Pharmacy / Doctor's Surgery.

Current office occupiers include Sysnet, Tech Data, Timewise Systems, Creditsafe, IP Telecom, Monster Energy, Enviroguide and Island Networks.

Opportunities exist for restaurants, opticians, fashion, barbers, hairdressers, florists, gift shops bookmakers and offices.

➔ For more information visit parkwest.ie



Floorplans

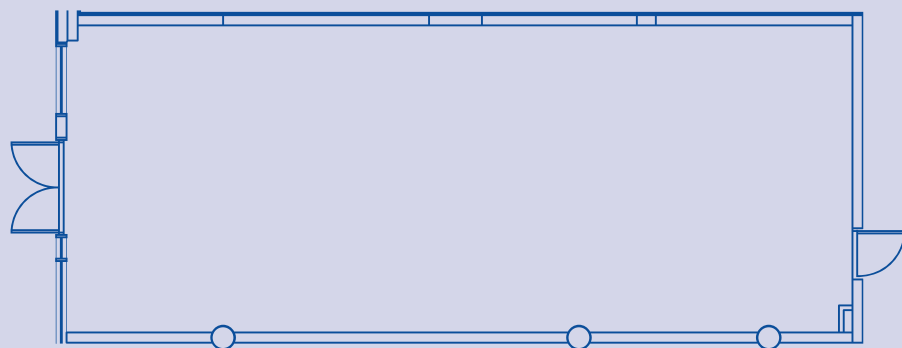

Unit 4

Sq ft: 1,151

Sq m: 107

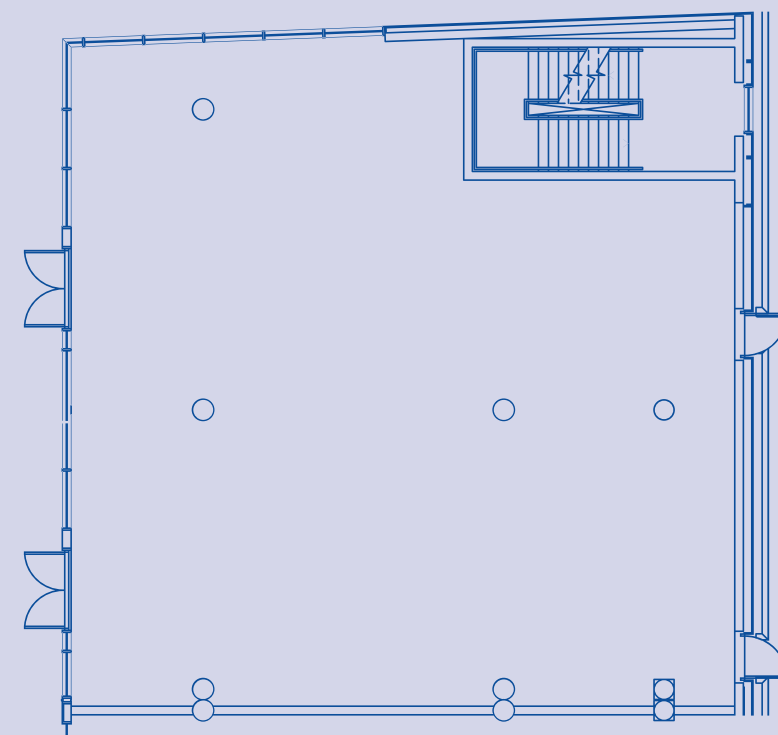

Unit 6/7

Sq ft: 2,690

Sq m: 250

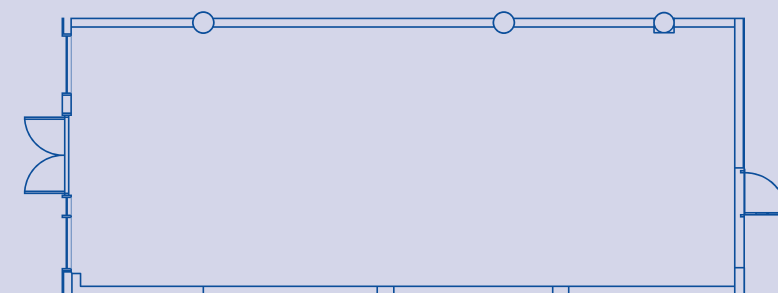
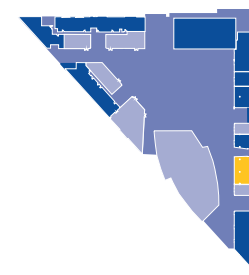

Unit 8

Sq ft: 1,151

Sq m: 107

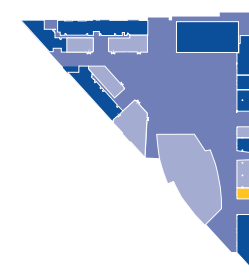

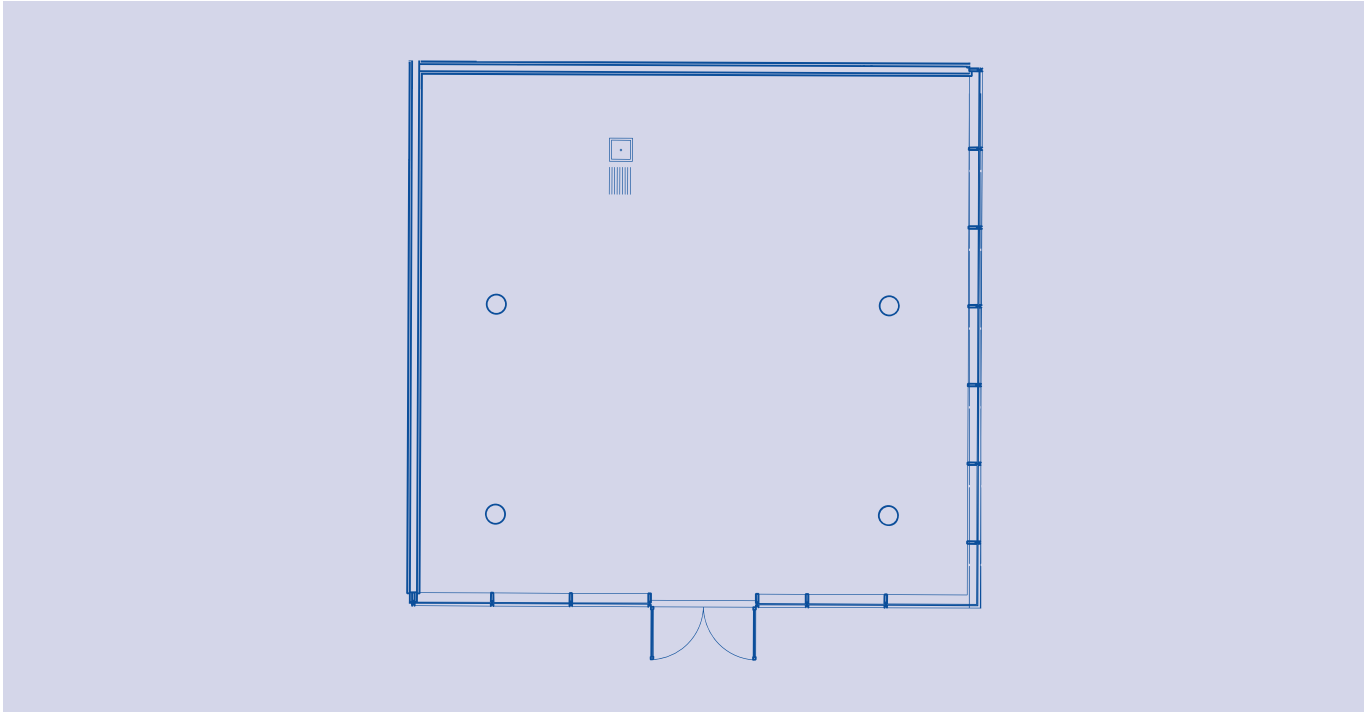

Unit 11

Sq ft: 1,108
Sq m: 103

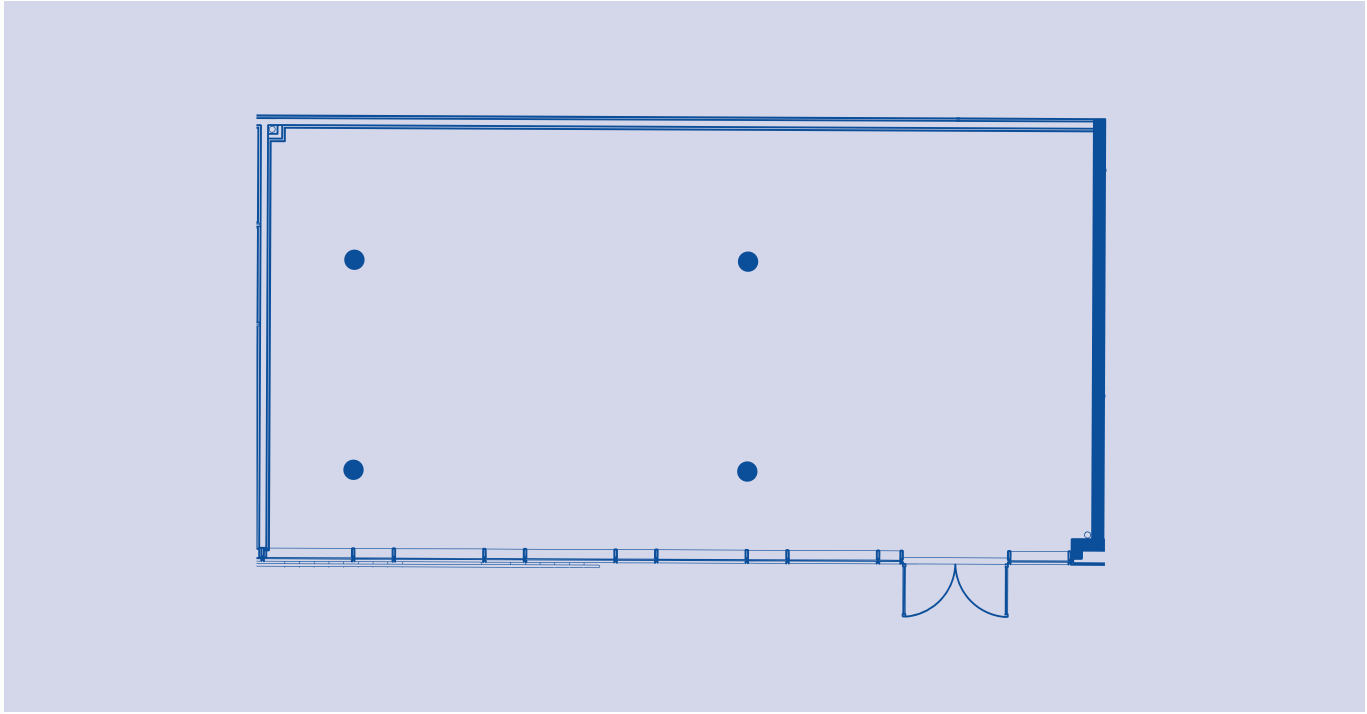

Unit 14-16

Sq ft: 1,345
Sq m: 125

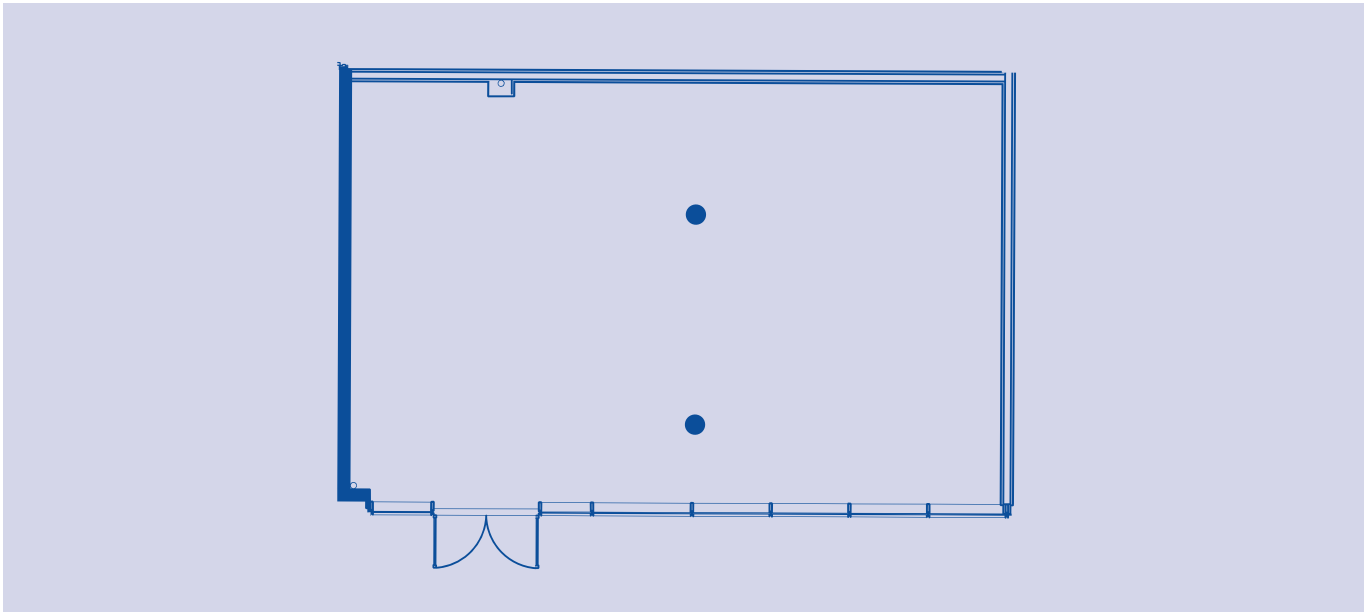

Unit 12/13

Sq ft: 1,065
Sq m: 99

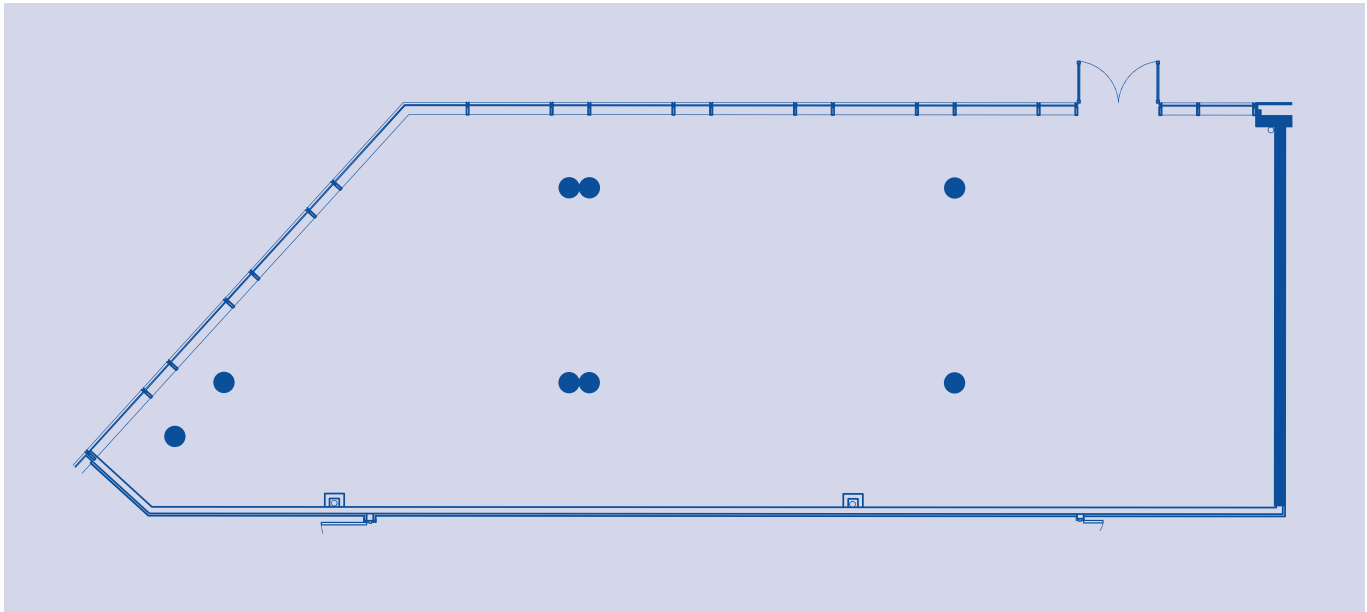

Unit 17-19

Sq ft: 1,840
Sq m: 171



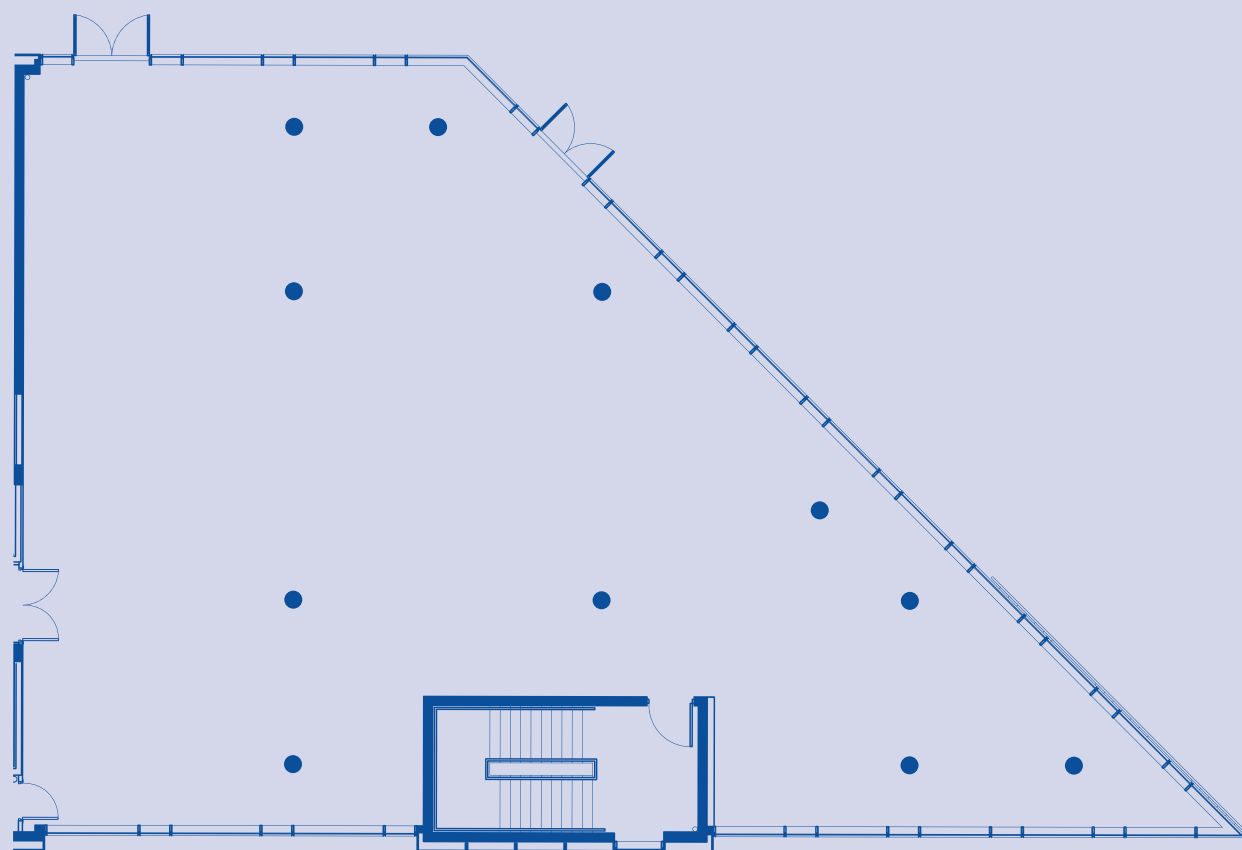

Unit 20-22

Sq ft: 3,724

Sq m: 346

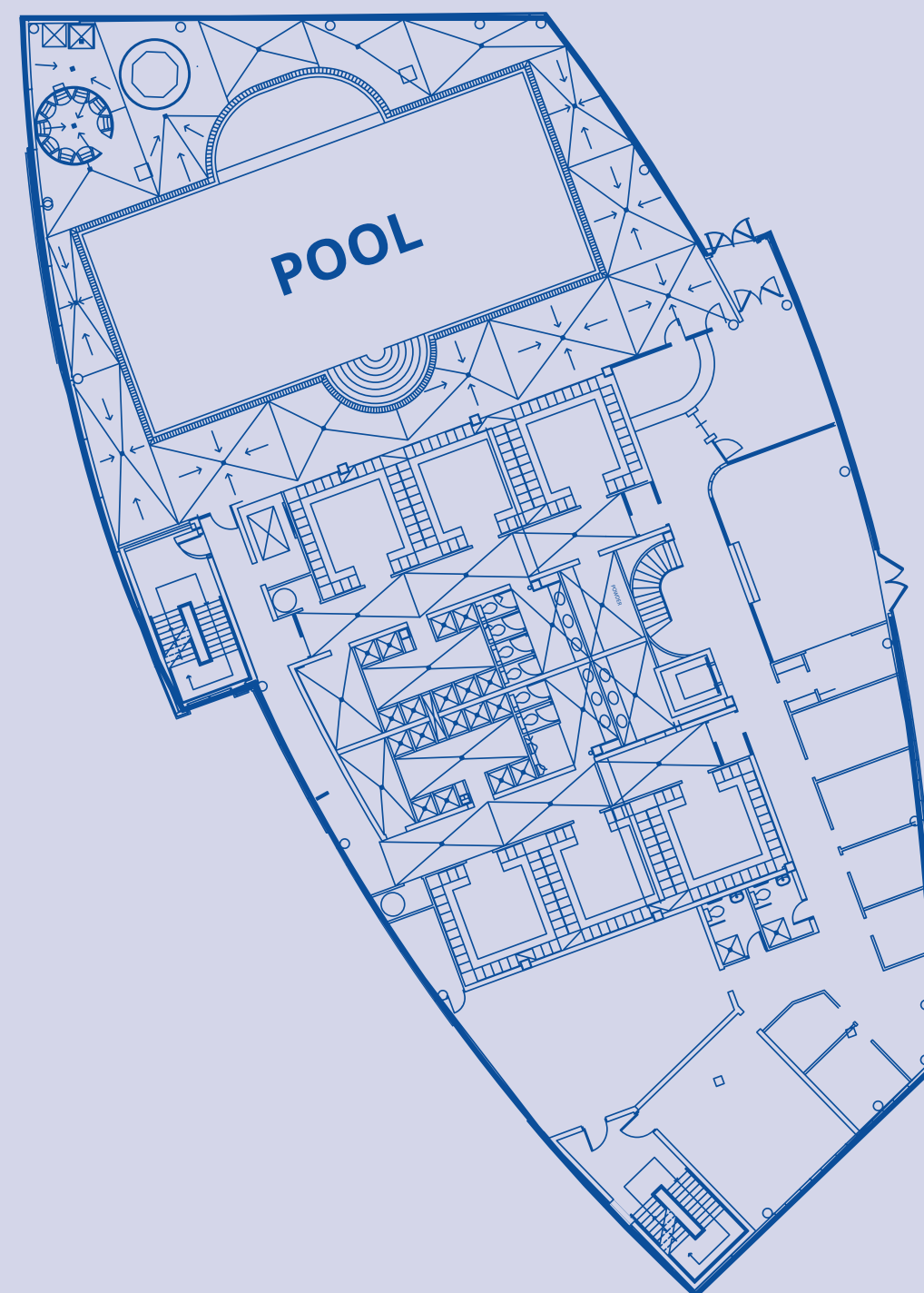

Block 73

Sq ft: 25,000

Sq m: 2,323

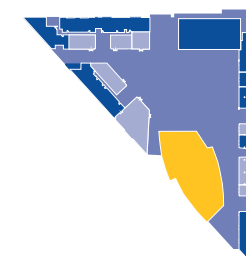

Surrounding area



Developer



harcourtdevelopment.com
T: 01 475 3928
PSRA 001528



parkwest.ie
T: 01 475 3928
PSRA 001880

Agents



harcourtdevelopment.com
T: 01 475 3928
PSRA 001528